

RoHS Compliant

REVISIONS			
REV.	DESCRIPTION	DATE	DESIGN

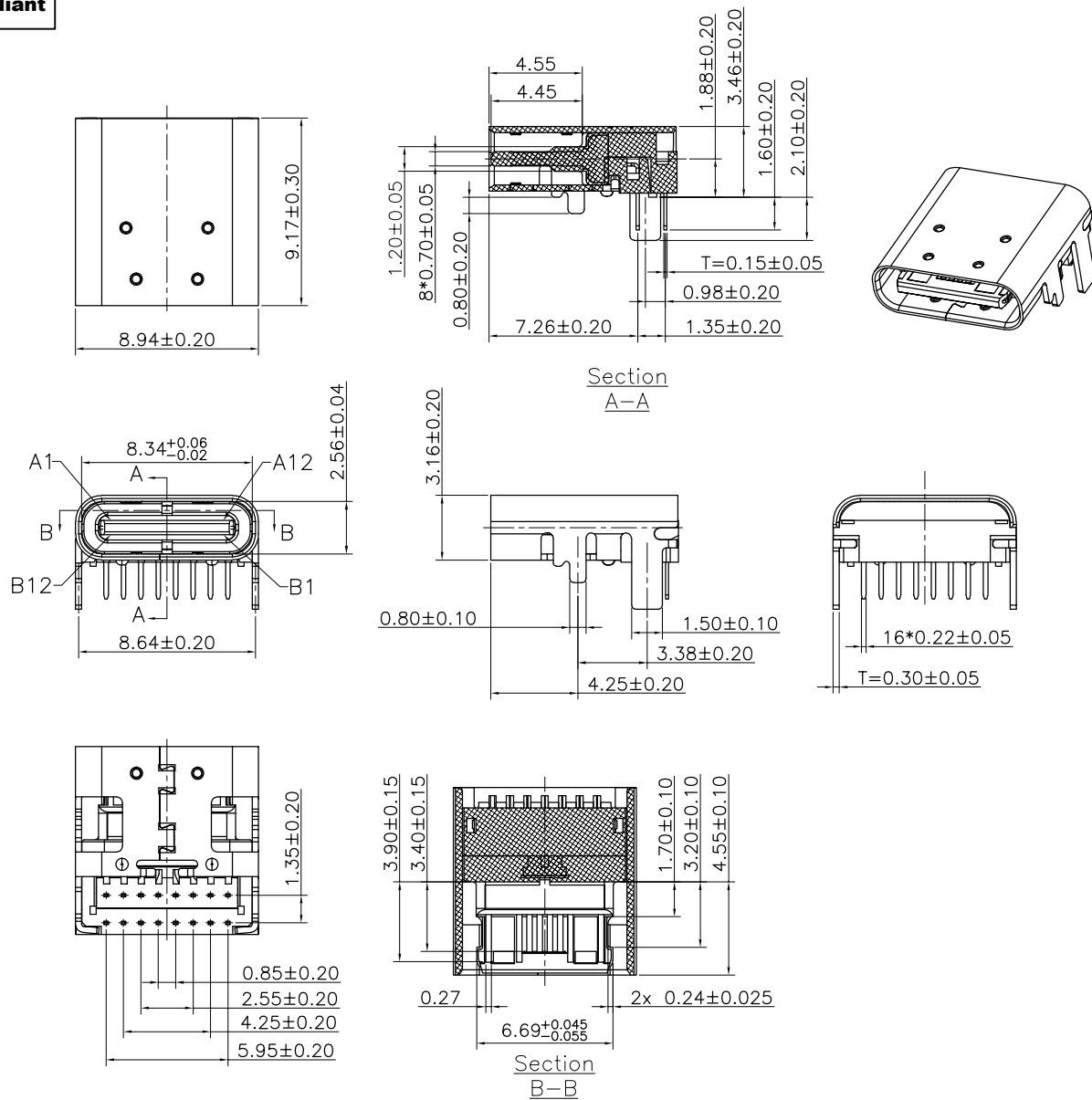

Specifications:

- 1.0 Electrical performance:
- 1.1 Contact resistance: 40mΩ max for initial, 10mΩ change after test, measure at 20mv, 100mA.
- 1.2 Dielectric withstanding voltage: AC 100V(rms).
- 1.3 Insulation resistance: 100MΩ min.
- 1.4 Contact current rating: 3A
- 1.5 Voltage: 20 Vac (rms).
- 2.0 mechanical performance:
- 2.1 Mating force: 5~20N
- 2.2 Unmating force: 8~20N Initial test, 6~20N After test
- 2.3 Durability: 10,000 cycles.
- 3.0 Environmental performance:
- 3.1 Temperature range:
- 3.2 Operating temperature: -40° to +85°.
- 3.3 Storage temperature: -20° to +60°.
- 4.0 Material:
- 4.1 Housing: LCP Black, UL94-V0.
- 4.2 Contact: C18400, T=0.15mm
- 4.3 Mid-plate: SUS301, T=0.15mm
- 4.4 Shell: SUS304 T=0.30mm
- 5.0 Plating specification:
- 5.1 Contact: Au (see table) plated on contact area
- Matte Tin plated 50u" min on solder area; Nickel 50u" min underplating over all.
- 5.2 Shell: 50u" min nickel plating.

PART NO. INFORMATION

U06-C F X X 5 X - 069

GENDER: F: FEMALE M: MALE	PORT TYPE C: TYPE C	CONTACT PLATED 1: GOLD FLASH 2: GOLD 3U" 3: GOLD 5U" 4: GOLD 10U" 5: GOLD 15U" 6: GOLD 30U"	PACKAGE T: TRAY R: TAPE REEL HOUSING COLOR 2: WHITE 5: BLACK 9: NATURE HOUSING MATERIAL A: LCP B: PBT C: PA9T D: PA6T E: PA46 F: PA66
---------------------------------	------------------------	---	--

Bestcreate Technology Limited

TOLERANCES UNLESS OTHERWISE SPECIFIED:

.X	± 0.30	X.	± 2'
.XX	± 0.20	.XX'	± 1'
.XXX	± 0.10	.XXX'	± 0.5'

Website: www.bsc-elec.com

Email: bestcreate@bsc-elec.com

DESIGN:
I. L

DATE:

CHECKED:

DATE:

APPROVED:

DATE:

TITLE:

USB TYPE C 16P FEMALE CONNECTOR DIP TYPE CH1.88

MATERIAL:

PART NO:
U06-CFXX5X-069

SIZE:
A4

FINISH:

DWG NO:
U06-CFXX5X-069

1 OF 2

REV: A	UNIT mm	SCALE 1=1	QUALITY SYMBOLS
-----------	------------	--------------	-----------------

RoHS Compliant

REVISIONS			
REV.	DESCRIPTION	DATE	DESIGN

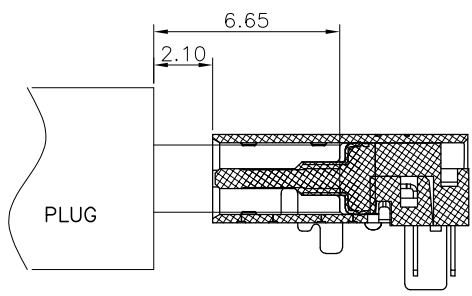

AFTER MATING

USB TYPE-C PIN ASSIGNMENTS

Pin	Signal	Mating Sequence	Pin	Signal	Mating Sequence
A1	GND	First	B12	GND	First
A4	Vbus	First	B9	Vbus	First
A5	CC1	Second	B8	SBU2	Second
A6	Dp1	Second	B7	Dn2	Second
A7	Dn1	Second	B6	Dp2	Second
A8	SBU1	Second	B5	CC2	Second
A9	Vbus	First	B4	Vbus	First
A12	GND	First	B1	GND	First
SHELL	GND		SHELL	GND	

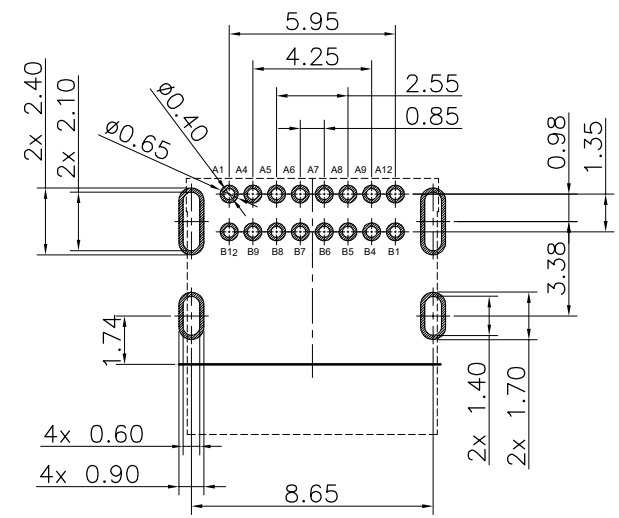

RECOMMENDED PCB LAYOUT(TOP)
TOLERANCES: ±0.05MM

Bestcreate Technology Limited

TOLERANCES UNLESS OTHERWISE SPECIFIED:			
.X	± 0.30	X.	± 2'
.XX	± 0.20	.XX'	± 1'
.XXX	± 0.10	.XXX'	± 0.5'
Website: www.bsc-elec.com			
Email: bestcreate@bsc-elec.com			

DESIGN:	DATE:
I. L	
CHECKED:	DATE:
C. W	
APPROVED:	DATE:
C. W	

TITLE:		
USB TYPE C 16P FEMALE CONNECTOR DIP TYPE CH1.88		
MATERILA:	PART NO:	SIZE:
	U06-CFXX5X-069	A4
FINSH:	DWG NO:	
	U06-CFXX5X-069	2 OF 2

REV:	UNIT	SCALE	QUALITY SYMBOLS
A	mm	1=1	