

RoHS Compliant

REVISIONS			
REV.	DESCRIPTION	DATE	DESIGN

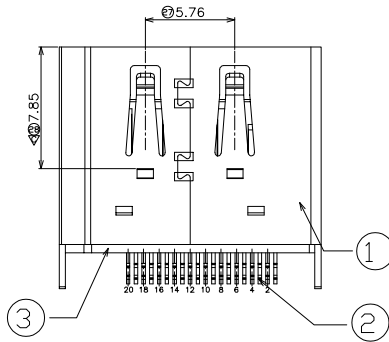
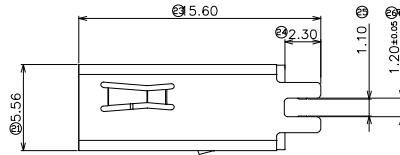
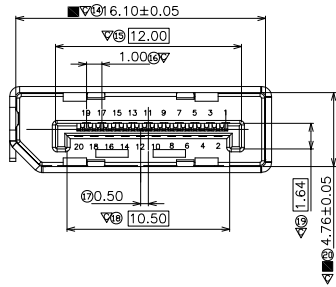
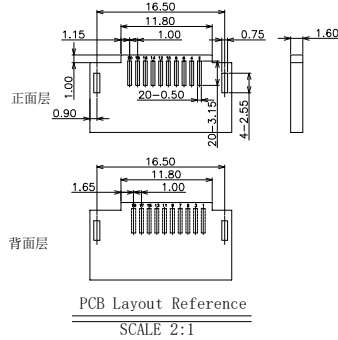
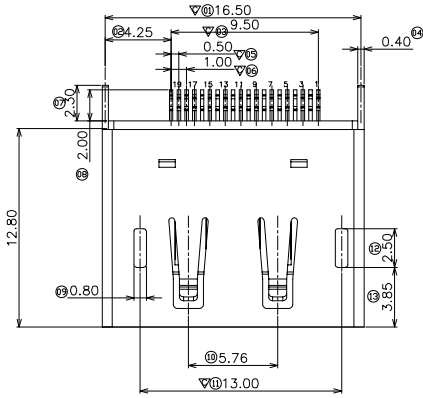

PIN	定义	PIN	定义
1	ML_Lane0 (P)	11	GND
2	GND	12	ML_Lane3 (N)
3	ML_Lane0 (N)	13	CFG1
4	ML_Lane1 (P)	14	CFG2
5	GND	15	AUX (HLP)
6	ML_Lane1 (N)	16	GND
7	ML_Lane2 (P)	17	AUX (HLP)
8	GND	18	HOT PLUG
9	ML_Lane2 (N)	19	Retarn (for Pwr)
10	ML_Lane3 (P)	20	DP-PWR (3.3V 500mA)

NONES:  
1. 电气特性:  
1) 接触阻抗: 30mΩ MAX (初始) FOR VBUS AND GND CONNECTS, 其它50mΩ MAX (初始)  
环境与寿命测试后的变化值: +10Ω MAX  
2) 绝缘阻抗: 100MΩ MIN.  
3) 额定电流: 1.5A  
4) 耐压: 100V AC (RMS)  
2. 机械特性  
1) 插入力: 35N MAX.  
2) 拔出力: 10N (初始) MIN.  
寿命测试后: 8N MIN.  
3) 寿命: 5000 CYCLES  
3. 环境特性: 使用温度: -40° C-85° C  
4. 符合本公司环境物质管理标准  
标记▽为重点管控尺寸.  
标记⊙为FAI尺寸.  
标记■为CPK尺寸.

PART NO. INFORMATION

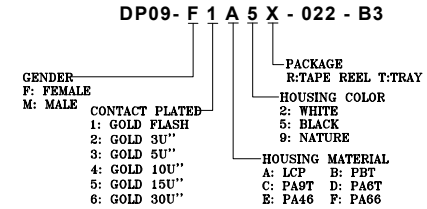

NO.	材料名称	材质	颜色	备注
3	外壳	SPCC	—	GOLD/NICKEL PLATED
2	端子	C2680	—	GOLD/TIN PLATED
1	胶芯	LCP	BLACK	UL 94V-0

**Bestcreate Technology Limited**

TOLERANCES UNLESS OTHERWISE SPECIFIED:

.X	± 0.35	.X'	± 2'
.XX	± 0.25	.X'	± 1'
.XXX	± 0.15	.XX'	± 0.5'

DESIGN: I.L  
DATE: 2017.3.1  
CHECKED: C.W  
DATE: 2017.3.1  
APPROVED: C.W  
DATE: 2017.3.1

TITLE: SADDLE MOUNT 1.2MM DP FEMALE CONNECTOR WITH CURVED PIN  
MATERILA: PART NO: DP09-F1A5X-022-B3 SIZE: A4  
FINSH: DWG NO: DP09-F1A5X-022-B3

Website: www.bsc-elec.com  
Email: bestcreate@bsc-elec.com

REV: A UNIT mm SCALE 1=1 QUALITY SYMBOLS